

# Opal Village

Pattaya, East Pattaya, Thailand  
Reference: 2368

฿35,900,000



5 Bedrooms



6 Bathrooms

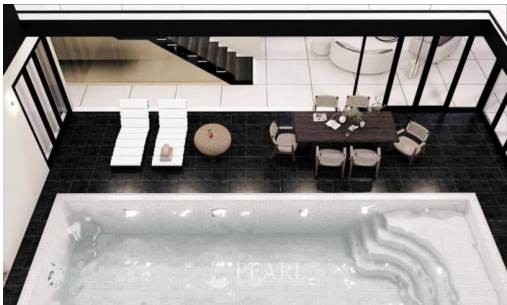

Villa

# Property Description

Introducing an exclusive property development Opalvillage boasting 8 luxurious houses, strategically located in proximity to Tara international schools and major motorways for unparalleled convenience.

Situated a mere 15 minutes away from the vibrant city center of Pattaya, these exquisite residences offer the perfect blend of tranquility and accessibility. Each meticulously crafted house will feature an impressive layout with 5 spacious bedrooms and 6 elegantly appointed bathrooms, providing ample space for luxurious living and entertaining.

With a generous size of over 598 square meters, these residences epitomize modern sophistication and offer an abundance of living space for discerning homeowners. From grand living areas to private retreats, every corner of these homes exudes luxury and comfort.

Beyond the luxurious interiors, residents will enjoy the convenience of being located close to renowned international schools, providing top-tier education options for families. Additionally, easy access to major motorways ensures seamless connectivity to other parts of the city and beyond, making daily commutes effortless.

Whether you're seeking a serene retreat away from the hustle and bustle of the city or a luxurious abode close to essential amenities, this property development offers the epitome of refined living.

# Photo Gallery



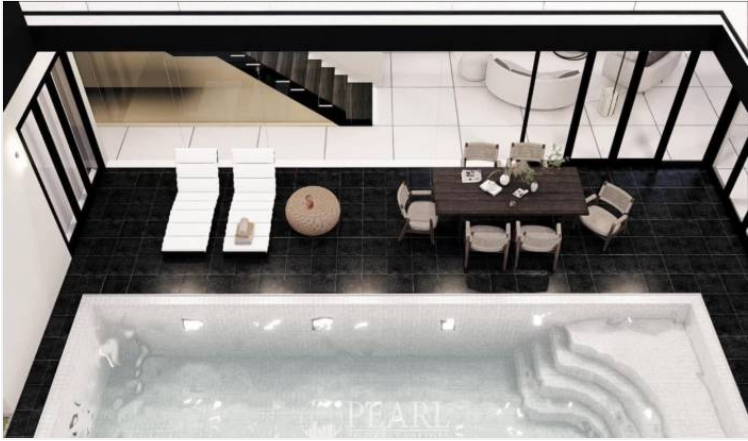

## Property Details

---

- **Property Type:** Villa
- **Location:** Pattaya, East Pattaya, Thailand
- **Price:** ฿35,900,000
- **Bedrooms:** 5
- **Bathrooms:** 6

## Property Features

---

- Security
- Swimming Pool
- Air Conditioning
- Balcony
- Car Park
- Electricity

## Location

---

image not found or type unknown

