

One Tower Pratumnak

Pattaya, Pratumnak, Thailand
Reference: 9982

฿6,500,000



1 Bedrooms

1 Bathrooms

Condo

Property Description

Introduction

Welcome to One Tower Pratumnak, an exquisite condominium project that epitomizes modern living in Pattaya. Developed by One Group Development Co.,Ltd, this property stands out for its prime location and luxurious amenities, offering a unique living experience.

Location and Neighborhood

One Tower Pratumnak is strategically located on a 2.1 Rai/3,218 square meter plot near the beach, adjacent to the renowned Cabbages & Condoms Resort, along Soi 4 Pratumnak on Pratumnak Hill. This prestigious location offers proximity to a small private beach and a 9-hole “pitch & putt” golf course, blending natural beauty with urban convenience. The area is known for its serene atmosphere, lush greenery, and breathtaking views over the Gulf of Thailand and the nearby Koh Larn.

Property Details

This high-rise condominium, completed in 2016, comprises a single building with 20 floors and a total of 218 units. Units vary in size, ranging from 30 sqm to 213.7 sqm, catering to different preferences and needs. Each unit is designed to maximize comfort and style, with options available from studio layouts to one-bedroom configurations.

Condition and Amenities

One Tower Pratumnak stands as a modern style high-rise, reflecting contemporary architectural design and state-of-the-art facilities. Residents can enjoy a range of amenities including a rooftop swimming pool offering 180° views of Pratumnak Hill and the Gulf of Thailand, a fully-equipped gym, dedicated security, and ample parking space. These features ensure a blend of luxury, security, and convenience, making it an ideal choice for both long-term living and vacation stays.

Financial Information

Pearl Property Pattaya

The maintenance fees for One Tower Pratumnak are reasonably set at ฿40 Baht per sqm, ensuring that the upkeep and services of the property are managed efficiently and effectively.

Contact Information

For more details or to schedule a visit, please contact Pearl Property:

- Tel: +66-33-135-053
- Whatsapp: +66-33-135-053
- Line: @pearlproperty
- Email: info@pearlpropertypattaya.com

One Tower Pratumnak presents an unparalleled opportunity to experience the best of Pattaya's living, combining luxury, comfort, and a prime location.

Photo Gallery



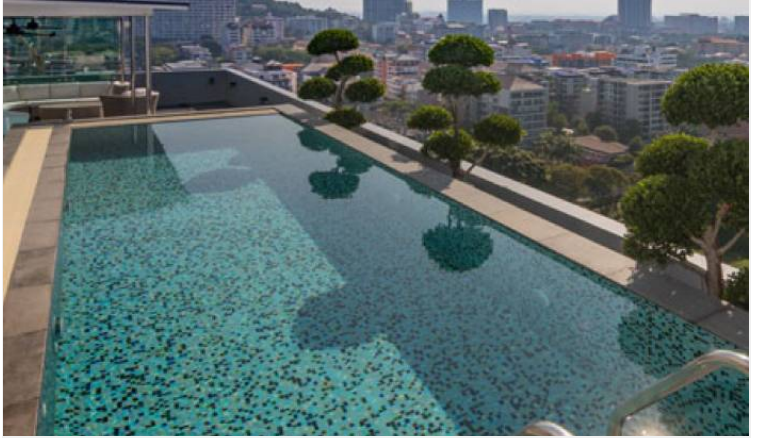
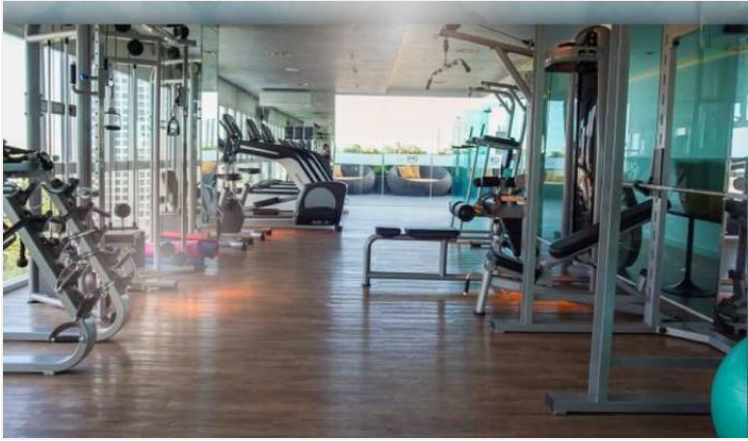

Property Details

- **Property Type:** Condo
- **Location:** Pattaya, Pratumnak, Thailand
- **Land Area:** 3840m²
- **Price:** ~~฿~~**6,500,000**
- **Bedrooms:** 1
- **Bathrooms:** 1

Property Features

- Security
- Gym
- Swimming Pool
- Air Conditioning
- Balcony
- Car Park
- Electricity
- Integral Kitchen
- Internet
- Alarm
- Concierge
- Guardhouse
- Lift
- Equipped Kitchen

Location

